





DO NOT SCALE

**KEY**

-  DIRECTION OF FLOW IN DITCH
-  EXISTING CONTROL STRUCTURE (INC STOPBOARDS)
-  EXISTING CULVERT CONNECTION BETWEEN DITCHES
-  SECTION NUMBER
-  DITCH TO BE REMOVED

| REV | DATE    | BY | DESCRIPTION | CHK | APP |
|-----|---------|----|-------------|-----|-----|
| A   | 4.03.09 | JP | FIRST ISSUE | JPD | JPD |

DRAWING STATUS: FOR INFORMATION ONLY



**WSP**

Kent House, Romney Place, Maidstone, Kent ME15 6JB  
 Tel: +44 (0)1622 760800 Fax: +44 (0)1622 760801  
<http://www.wspgroup.com>

CLIENT: LAA

ARCHITECT: LONDON-ASHFORD AIRPORT  
 LYDD

TITLE: DRAINAGE STRATEGY  
 DITCH TO BE REMOVED/REALIGNED

|             |            |               |            |           |            |
|-------------|------------|---------------|------------|-----------|------------|
| SCALE @ A2: | 1:2000     | CHECKED:      | JRD        | APPROVED: | JRD        |
| CAD FILE:   | 1559-GA-01 | DESIGN/DRAWN: | JP         | DATE:     | March 2009 |
| PROJECT No: | 11111559   | DRAWING No:   | 1559-GA-01 | REV:      | A          |

© WSP Group plc

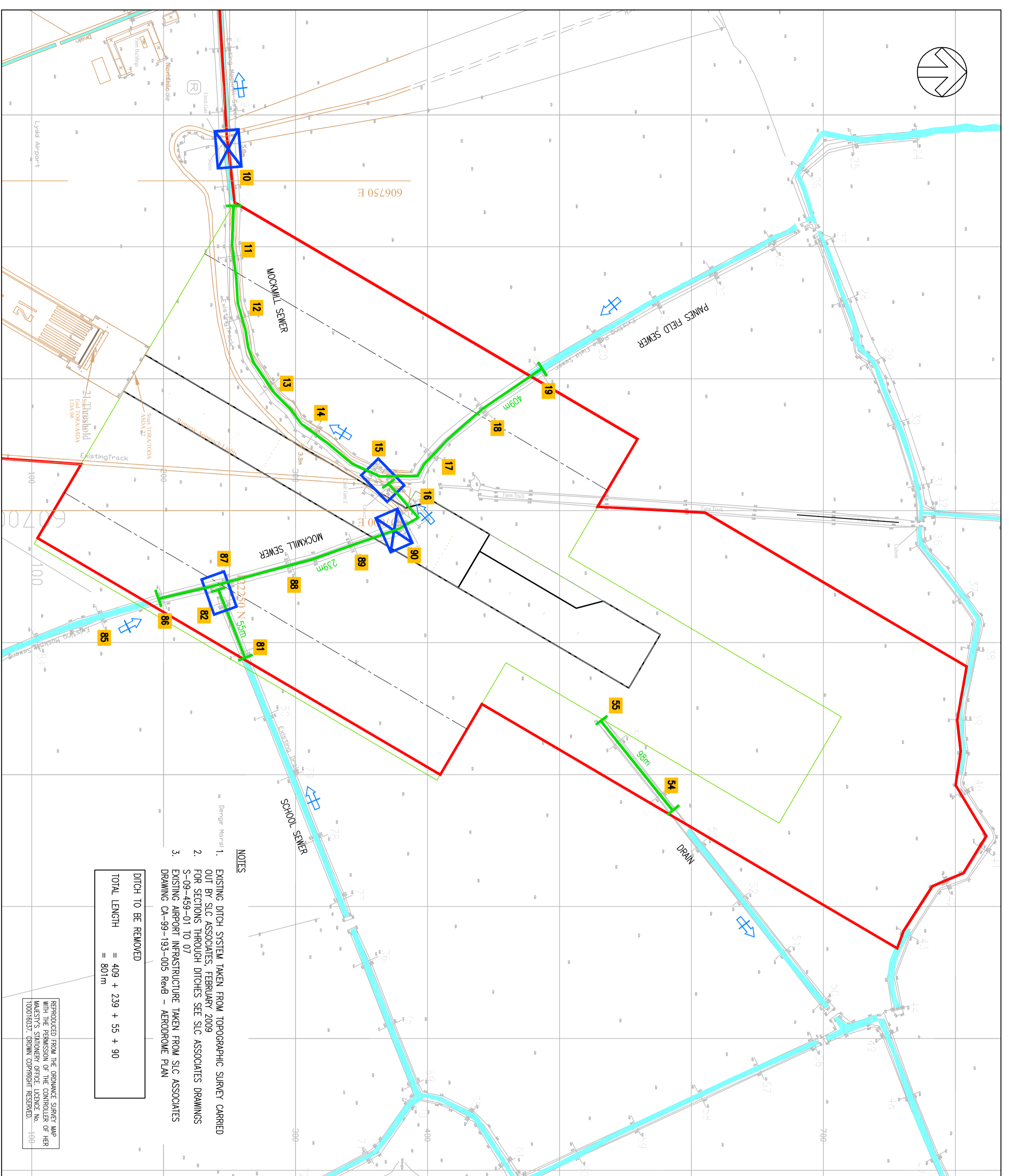

- NOTES**
- EXISTING DITCH SYSTEM TAKEN FROM TOPOGRAPHIC SURVEY CARRIED OUT BY SLC ASSOCIATES, FEBRUARY 2009
  - FOR SECTIONS THROUGH DITCHES SEE SLC ASSOCIATES DRAWINGS S-09-499-01 TO 07
  - EXISTING AIRPORT INFRASTRUCTURE TAKEN FROM SLC ASSOCIATES DRAWING CA-99-193-005 RevB - AERODROME PLAN

DITCH TO BE REMOVED  
 TOTAL LENGTH = 409 + 239 + 55 + 90  
 = 801m

REPRODUCED FROM THE ORDNANCE SURVEY MAP WITH THE PERMISSION OF THE CONTROLLER OF HER MAJESTY'S STATIONERY OFFICE. LICENSE No. 100 00070037. CROWN COPYRIGHT RESERVED.